



Schrebergarden 2.0 Community Farm

Dedicated to an urban-rural
balanced lifestyle

urban  **rural**
partnership



Copyright © 2020-2023 Urban Rural Partnership



City people are more desired for outskirts living retreat in the Post COVID era.

Schrebergarden allotments are more and more popular in the metropolitan area. Waiting lists are long for many years. Open up more sites will meet the growing demand.

The current Schrebergarden model needs to be upgraded towards the form of living friendly, community sharing, openness for society.



Urban rural balanced lifestyle makes city people more healthy, community more inclusive and vibrant.



Mission

4

To create the New Schrebergarden community farms in the outskirts of metropolitan, featuring organic farming, sustainable living and nature school together.



Business components

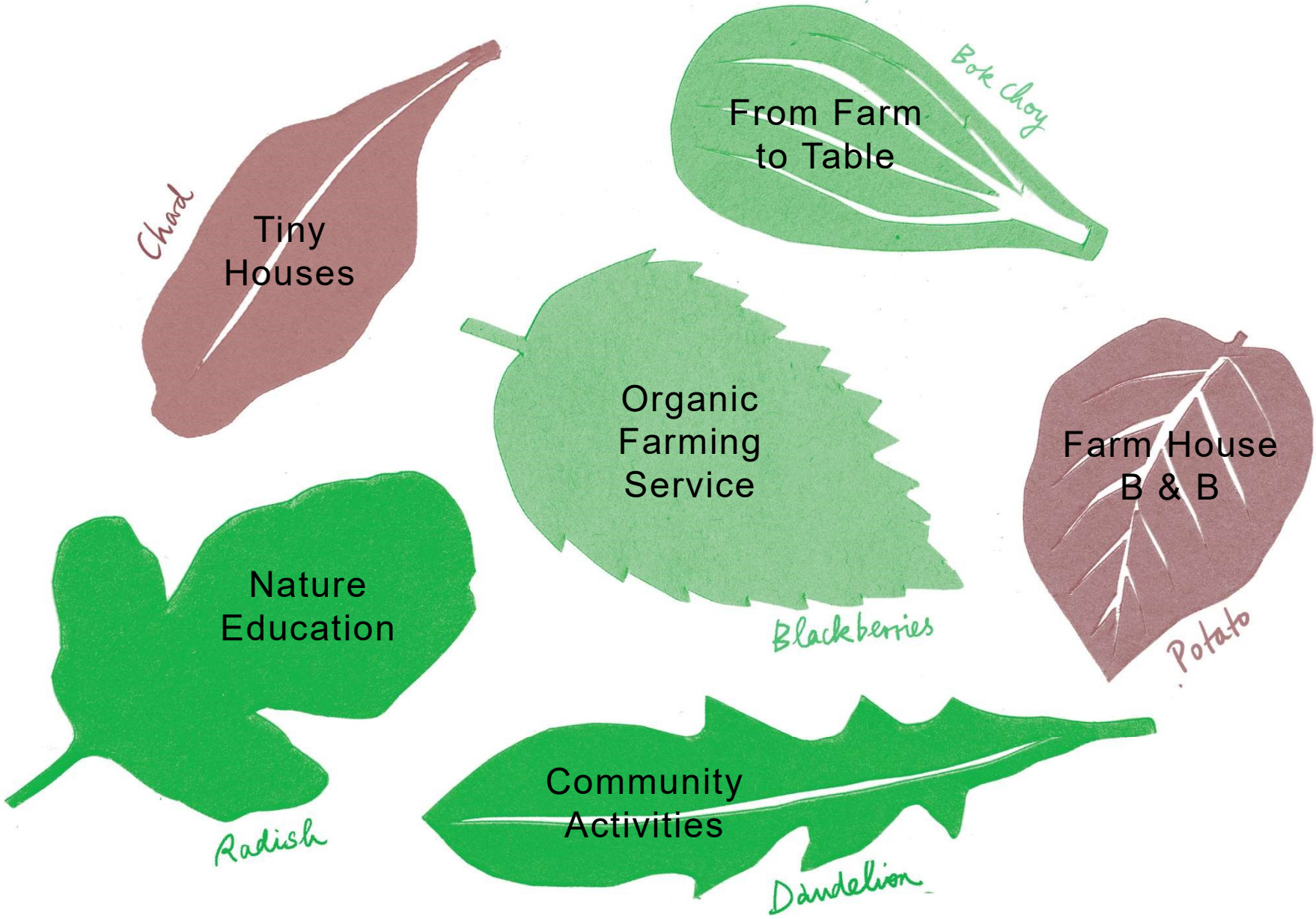

Our prototype in Shanghai: Schrebergarden Community Farm since 2010



Photo © URP, 2020

The first Schrebergarden community farm in Shanghai was founded in 2010 with a 8.5-hectare land, 50km from city center. Currently the community has more than 200 family members and 400 Schrebergarden plots.



New design for The New Schrebergarden Community Farm (100m x 100m)

- Shared vegetable garden
- Second home plots
- Mobile tiny houses
- Energy & water self supplied
- Mixed land use
- Embedded
Community
Supported
Agriculture (CSA)

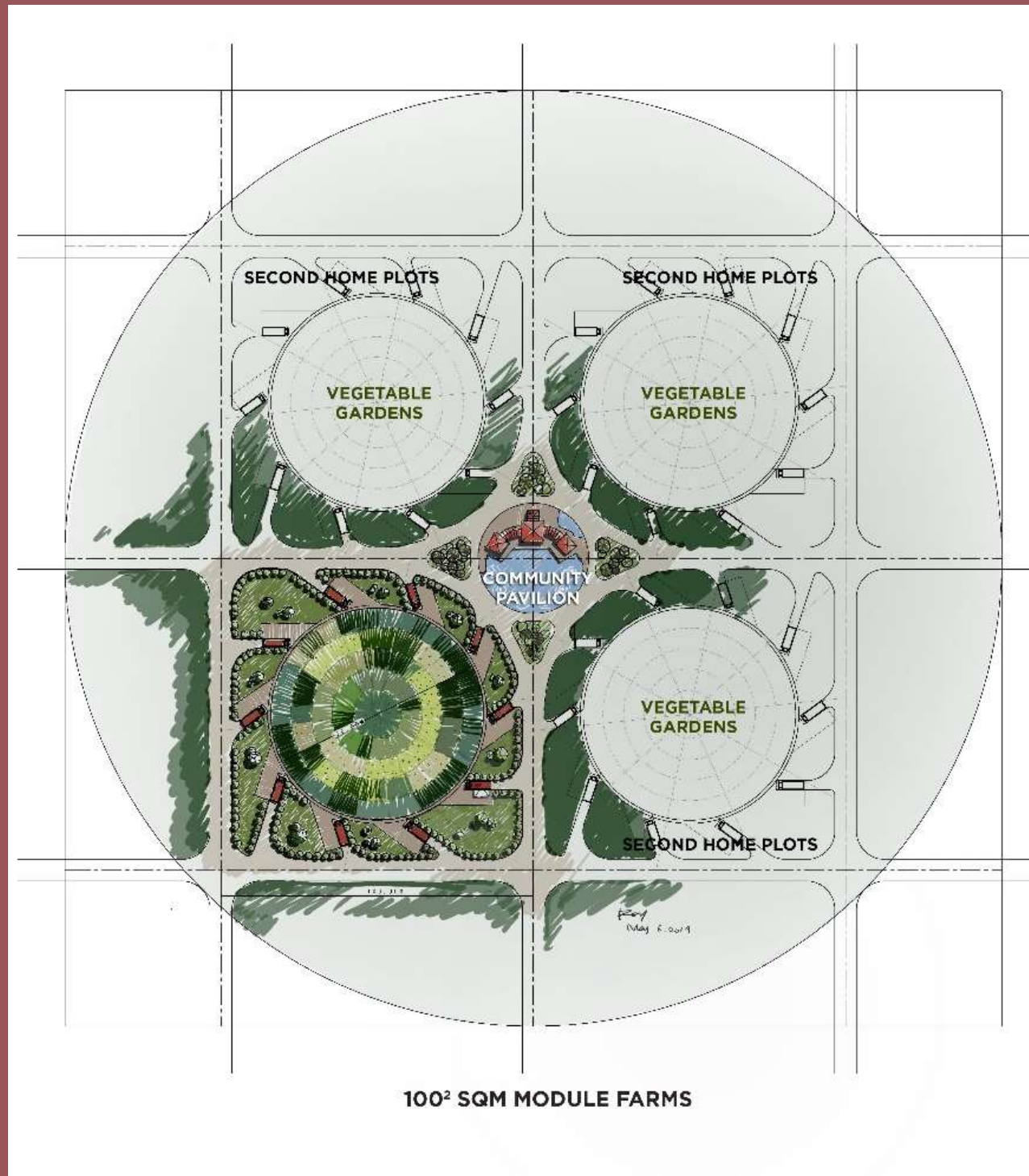

Products and Services

Organic Farming Service
Making your work easier

8



4 seasons

60+ different vegetables
planted

8*8 meter per unit plot

Day care/on call garden
service





- 🍃 Bio-agriculture
- 🍃 Nature Art & Craft
- 🍃 Nature Engineering
- 🍃 From Field to Table
- 🍃 Scouting Camp



Products and Services

Digital Farm E-connecting farm and families



Digital Services – Business to Customer

Schrebergarden Community Farm Applet

(Example of Shanghai Project)

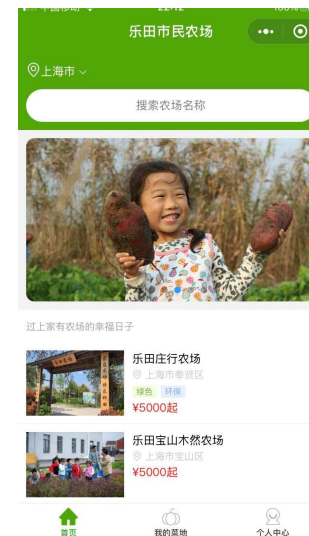



**Business idea: Cooking Class
in the New Schrebergarden**

Photo from internet

Self-sustaining business with good social benefits

(Example of Shanghai project)

 **5000** RMB (ca.700 EURO)
per unit per year membership fees

 **400** plots

 **2+** Million RMB annual revenue
(ca. 300k EURO)

 create **10** full time/part time jobs

 enables **200+** local families to embrace a healthy lifestyle

 encourages **1000+** kids to participate our nature curriculum

 fosters biodiversity and multi generation interaction for the local community

 promotes cultural exchange with **multi** nationalities





urban rural partnership

Office in China
URP Co. Ltd.
999 Da-Ting Highway
Fengxian District
Shanghai, P.R. China

Office in Germany
URP GmbH
Marie-Curie Str. 6
85055 Ingolstadt

Dr.pantao@gmail.com

Download our Applet
for WeChat:

